



Key:

- 1 Formalise existing gravel carpark. Reduce footprint by arranging parking and aisle widths to meet AS 2890.1. Resurface with bitumen and include linemarking and wheel stops. Improve exit sight lines through the removal and trimming of existing vegetation. Install new gravel trail connections and revegetate with endemic coastal planting.
- 2 Retain existing foot bridge including sculptural elements either end of the bridge.
- 3 Stabilise canal bank and revegetate.
- 4 Resurface existing gravel trail throughout the park. Ensure positive drainage. Create uniform width of 2.4m across park.
- 5 Remove existing concrete platform and stairs. Stabilise bank and revegetate.
- 6 Stabilise canal bank, re-establish grassed area with irrigation and sub surface drainage. Revegetate endemic coastal planting. Retain existing small beach section for use by model boat enthusiasts.
- 7 Upgrade existing stormwater infrastructure as required. Consider integrating with timber viewing deck structures to screen infrastructure and allow users to step out and down to the canal edge.
- 8 Upgrade existing seating and provide additional seats along the loop track to reduce distance between rest stops.
- 9 Engage arborist to remove dangerous limbs or trees and establish succession planting strategy across park.

- 10 Rationalise provision and location of parking. Define and formalise 90° parking to comply with AS 2890.1. Provide bitumen surface, linemarking and wheel stops as required.
- 11 Relocate bus stop in consultation with Metro, remove parking, formalise trail connection and revegetate.
- 12 Formalise existing carpark layout to meet AS 2890.1. Integrate new bus stop and footpath. Remove parking area from cafe entrance – allow designated deliveries only space. Provide DDA ramp from carpark on North Terrace down to day use area.
- 13 Replace existing shelters with new public shelter including accessible BBQs and picnic tables. Re-establish grassed day use area with irrigation and sub surface drainage.
- 14 Install new interpretation panels highlighting significant features of the park. Develop wayfinding strategy for park and provide new directional signage at suitable locations and intervals.
- 15 Trim vegetation to improve vehicle and pedestrian sightlines around corners and into car parking areas.
- 16 Change road surface and introduce roadside vegetation and kerb bulbing for safer pedestrian crossing point to connect park to beach. Consider lowering speed limit to 40kph. Formalise parking arrangement to meet AS 2890.1 (indicative parking layout shown). Improve pedestrian links to new toilet block.
- 17 Provide sheltered picnic and viewing area in location of old toilet block.
- 18 Trailer parking. Layout indicative subject to detail design.

- 19 Formalise parkside edge of North Terrace. Remove gravel shoulder and provide flush concrete edge to road surface. Use bollards and planting to better define edge of park and eliminate informal parking.
- 20 New timber boardwalk to connect loop path around waters edge and limit damage to saltmarsh. Revegetate canal bank with endemic coastal planting. Provide step and ramp access connecting to main loop path.
- 21 Provide safer pedestrian crossings points into the park along North Terrace and South Terrace. Introduce traffic calming devices such as roadside vegetation, kerb bulbing at crossings and improved pram ramp infrastructure.
- 22 Upgrade Icy Creek Lane pedestrian and Tangara Trail link. Min 2.4m gravel path. Revegetate grassed areas with endemic coastal planting and trees to create habitat enhancement corridor. Install bollards along roadway to remove informal parking. Existing property access from Icy Creek Lane will be retained.
- 23 Upgrade existing pedestrian crossing point on South Terrace from Hill Street Grocer. Opportunity to review parking arrangement and circulation within the Hill Street Grocer carpark and at entry point.
- 24 New play precinct with multiple play opportunities for all ages including, New public shelter including accessible BBQs, picnic tables and toilet facilities. Potential future market space, interpretation point, art, seating and social space. Upgrade existing concrete and gravel paths to min 2.4m wide exposed aggregate concrete paths. Install new perimeter fencing with controlled entry points from South Terrace
- 25 Existing skatepark to be upgraded.
- 26 Integrated hard surface play area with half court basketball court, ball games area, table tennis, bike/scooter circuits and parkour course.

- 27 New urban playground area with swings, see-saws and climbing structures including balancing elements, slides and climbing walls.
- 28 Re-establish grassed picnic area within fenced playground. Include shade trees, irrigation and sub surface drainage.
- 29 New nature play playground area with balancing logs, log hop, climbing nets and native planting.
- 30 New carpark to service main activity hub and play precinct. Provide new pedestrian refuge for safer crossing of South Terrace.
- 31 New pedestrian/cycle path bridge linking Bangalee Street to Icy Creek Lane offering views along the canal and out to Frederick Henry Bay.

Legend:

- Resurfaced/ New compacted gravel footpath. Min 2.4m wide.
- New exposed aggregate footpath. Min 2.4m wide
- New boardwalk. Min 2.4m wide
- Revegetate area with endemic coastal planting
- Re-establish grassed area with irrigation, sub surface drainage and edging
- Nature play space (eg. balancing logs, log hop and climbing nets)
- Urban play space (eg. swings, slides and climbing structures)
- Skate park with integrated hard surface play space (eg. table tennis, half court basketball, parkour course and seating)
- New timber viewing decks with gravel access path and native planting
- New accessible BBQ shelter and picnic facilities
- New accessible public toilet (to be constructed in 2021)
- New public shelter with accessible toilets, BBQs and picnic facilities
- New park seating provided every 50-60m on main loop path
- Timber bollards along open grass sections
- Fencing around play precinct

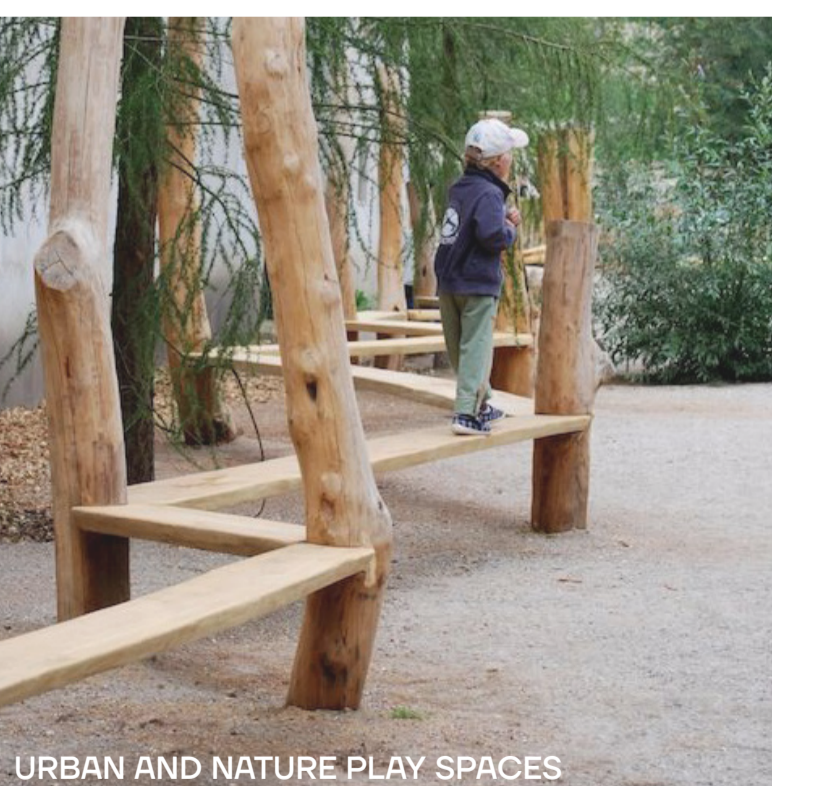
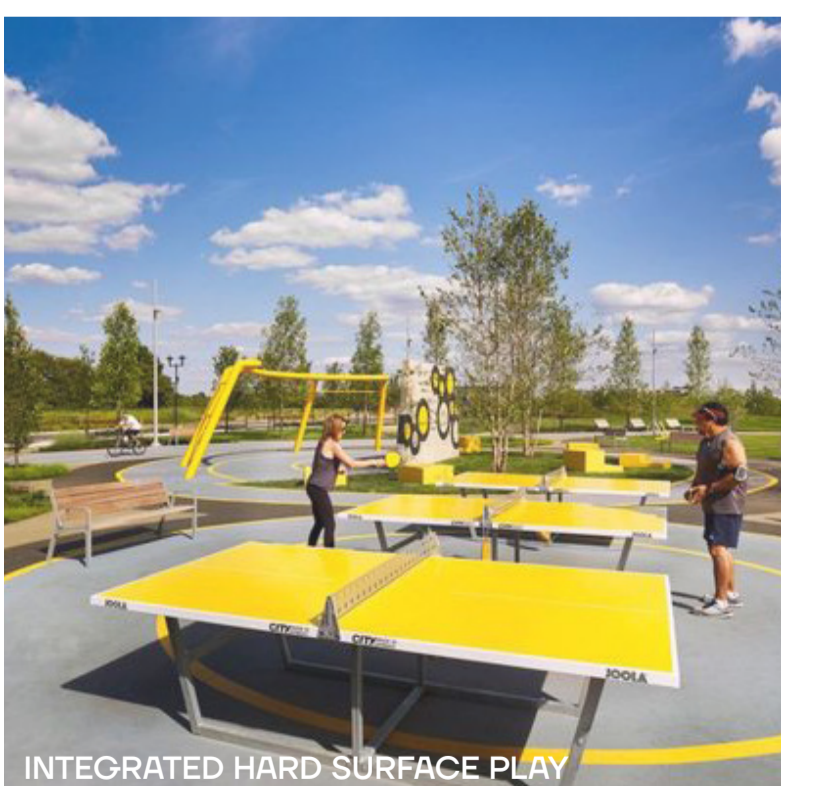

LAUDERDALE CANAL PARK MASTER PLAN

Lauderdale Canal Park, Lauderdale | Draft For Review
 PREPARED FOR CLARENCE CITY COUNCIL